

A Clean Slate

WITHOUT TEARING DOWN A SINGLE WALL, A MONTREAL DESIGNER TOTALLY TRANSFORMS AN ENSUITE BATHROOM.

Photography by Monic Richard



Fast Facts

DESIGNER Jean Stéphane Beauchamp

VISION A timeless ensuite for a husband and wife with low-maintenance finishes and luxe amenities, including a steam shower, heated floors and heated towel rack.

TIMELINE 8 weeks

SIZE 122 sq.ft., 9½'-high ceilings

TOTAL BUDGET \$65,000

KEY COSTS

\$15,640 Steam shower
\$7,900 Tile
\$7,780 Vanity + faucets
(includes retrofit upgrades
and installation)
\$1,100 Tub refinishing



*Pale grey walls
soften the black and
white scheme*

**AFTER:
Calming & Clean**

*The ready-made vanity
was upgraded with
soft-close drawers*

Bathrooms • BEFORE & AFTER



The Floorplan

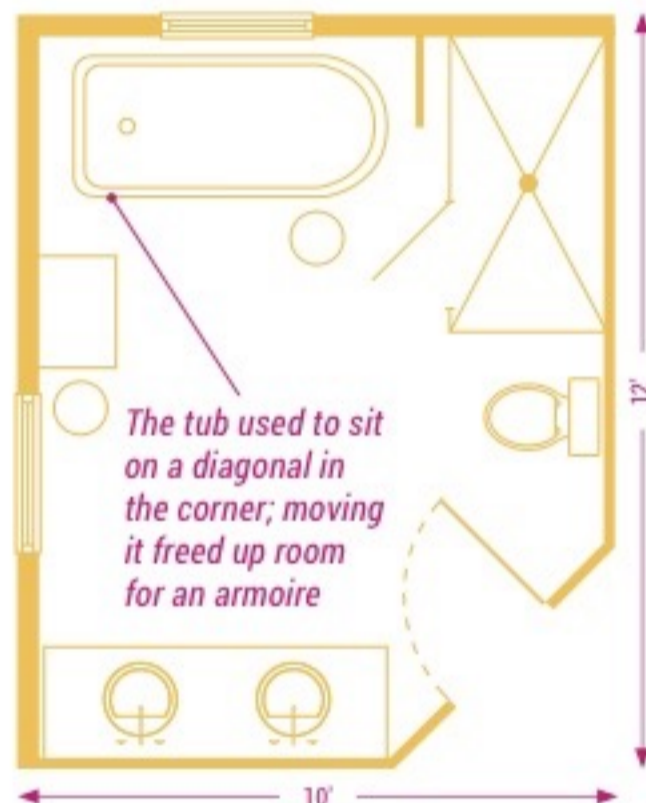

THE MAKEOVER

Shower + Tub

The homeowners had their hearts set on a steam shower, so a top-end ventilation system was installed to keep humidity in check. To ensure proper drainage, the floor joists were shaved down 1 1/2" to slope the floor, and the ceiling above was lowered. The previous owners had a beautiful antique tub, so Jean Stéphane had it re-enamelled inside and powder-coated dark grey outside — a refresh that took a month to complete.

Tile

Subway tile now covers the lower portion of the walls for a classic look. "Everyone loves subway tile," says Jean Stéphane. He chose a ceramic tile with texture, then topped it with moulded tile trim. "It gives the bathroom vintage flair." Square tiles on the upper wall and ceiling in the shower echo the square matte-enamelled glass tiles on the floor. A subfloor was removed to create space for radiant heating and to keep the bathroom floor level with the adjacent room.

Vanity + Fixtures

Jean Stéphane sourced a vanity from RH Restoration Hardware, then added the Corian countertop in a satin finish. "Unlike marble, Corian is resistant to everything," he says. Chrome faucets wipe clean easily and nearly disappear against the white tile. Two tall, narrow mirrors balance the weight of the vanity and punctuate the wall. The new brass sconces were a lucky match with the existing antique chandelier.



The homeowner loves purple, so I did a pale lavender on the ceiling that almost looks grey.



RENO IN REVIEW



Jean Stéphane
Beauchamp

BIGGEST COMPROMISE

"We wanted to do a gorgeous tone-on-tone mosaic tile floor, but it would have cost \$43,000. So we did it in the powder room instead."

WHAT HE WOULD DO DIFFERENTLY

"I would control all the lights from a single control panel. It's much more expensive than individual switches, but it's a cleaner look."

LESSON LEARNED

"I'm not sure I would retrofit another vanity. Upgrading the drawers was tricky. In the end, we only kept the fronts and rebuilt the boxes."

Contracting, 1M2; **tiles**, Ceragres; **vanity, armoire**, RH Restoration Hardware; **counter**, Summum Granit; **sconces**, new glass chandelier shades, Schoolhouse Electric & Supply Co.; **faucets, sinks, toilet, steam generator, towel warmer**, Batimat; **side table**, Celadon; **suitcase rack** (above toilet), **towel ring, towels, bathmat, roman shades**, Qui Dort Dine; **plates** (on wall), Laura Zindel Design; **ceramic drum table**, Dcovia; **flowers**, Fauchois Fleurs; **wall colour**, Stonington Gray (HC-170), **trim colour**, Oxford White (CC-30), Benjamin Moore; **ceiling colour**, Calluna (270), **vanity colour**, Off Black (57), **armoire colour**, All White (2005), Farrow & Ball.